

Press release

Digital solutions: efficient processes for construction sites of the future

- **Comprehensive crane information models help with custom-fit crane selection**
- **Modern Tower Crane OS user interface for optimal usability**
- **Relevant data provides reliable overview of quality and construction progress**

Digitalization offers the construction industry diverse opportunities for increased performance, reliability and safety on site. As a holistic solutions provider, Liebherr Tower Cranes shares insights into new digital developments around crane operation at Conexpo 2023 in Las Vegas. Comprehensive planning, efficient processes and spot-on analysis – all made possible by Liebherr’s new tools.

Las Vegas (USA), March 14, 2023 – Liebherr launches comprehensive Crane Information Models (CIMs) for precise construction site planning over the coming months. These models make the work of architects and construction planners easier, as they allow key information regarding crane deployment to be considered early in the process, ensuring the right choice of crane for the job at hand. With decades of accumulated expertise, Liebherr’s Tower Crane Solutions, project department, also provides support with cost-effective construction site planning.

Intuitive operation for efficient load handling

Further improvements for more efficient load handling are also in the spotlight. The user interface of the Tower Crane Operating System (Tower Crane OS), for example, offers tailored menus, a wide choice of languages and relevant units of measurement to crane operators and assembly engineers to easily select the parameters most relevant to their work.

Users navigate their way through the streamlined menu structure via touchscreen. Display masks can be combined in different ways to maintain an overview during crane operation and scaling. The user-friendly display featured in several cranes ensures that training and familiarization times are reduced.

Site monitoring with transparent information

The right data is useful in evaluating the success of a construction project on its completion. Although every construction site is different, it is nevertheless possible to learn from processes for subsequent projects. This is where Liebherr’s digital “Site Monitoring” solution comes into play. Relevant crane data

can be easily recorded, displayed and analyzed. Such information also provides site supervisors and construction planners with a reliable overview of efficiency and construction progress.

Liebherr supports architects, construction planners, supervisors and others working on site with its “Plan and Analyze” concept for optimum workflows. Digital construction planning and downstream analysis with transparent information play a decisive role in the success of tower crane operations. To this end, Liebherr offers customized solutions and tools to make the most of opportunities arising from digitalization.

About Liebherr USA, Co.

Liebherr USA, Co. based in Newport News, VA provides sales and service on behalf of ten different Liebherr product segments: earthmoving, material handling, mining, mobile and crawler cranes, tower cranes, concrete technology, deep foundation machines, maritime cranes; components, and refrigeration and freezing.

About the Liebherr Tower Cranes Division

More than seven decades of experience have made Liebherr a recognised specialist for lifting technology on all types of construction sites. The range of Liebherr Tower Cranes encompasses an extensive selection of high-quality tower cranes that are used worldwide. This includes fast-erecting, top-slewing, luffing jib and special-purpose cranes as well as mobile construction cranes. In addition to these products, Liebherr also offers a wide range of services that complete the company’s portfolio: Tower Crane Solutions, the Tower Crane Center and Tower Crane Customer Service.

About the Liebherr Group

The Liebherr Group is a family-run technology company with a highly diversified product portfolio. The company is one of the world’s largest manufacturers of construction machinery. It also offers high-quality, user-oriented products and services in multiple other areas. Today, the group consists of more than 140 companies across all continents. In 2021, it employed more than 49,000 people and achieved combined revenues of over 11.6 billion euros. Liebherr was founded in 1949, in Kirchdorf an der Iller in southern Germany. Ever since then, the company’s employees have been committed to satisfying customers with advanced solutions and to helping drive technological progress.

Images

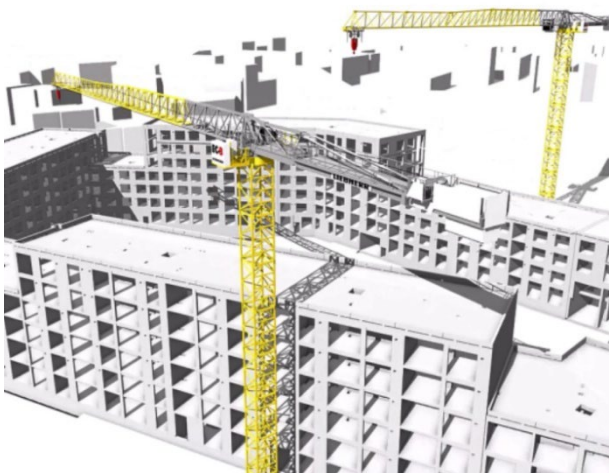

liebherr-digital-solution-01.jpg

IFC models of EC-B series flat-top crane support construction site set-up as a digital product.



liebherr-digital-solution-02.jpg

Clear overview: The Tower Crane Operating System impresses with its streamlined menu structure on a twelve-inch touchscreen display.

Contact

Daniel Haefele
Global Communication
Liebherr-Werk Biberach GmbH
Phone: +49 7351 / 41 - 2330
Email: daniel.haefele@liebherr.com

Ana Cabiedes
Head of Marketing
Liebherr USA, Co
Phone: +1 757 240 4250
E-mail: ana.cabiedes@liebherr.com

Published by

Liebherr-Werk Biberach GmbH
Biberach / Germany
www.liebherr.com